

Specifications

Nominal Voltage	12V	
Nominal Capacity (20HR)	30AH	
Dimension	Length	167mm (6.56 inches)
	Width	125mm (4.92 inches)
	Height	177mm (6.97 inches)
	Total Height (with Terminal)	177mm (6.97 inches)
	Approximate Weight	9.1 kg (20 lbs)
Battery Type	Valve Regulated Lead-Acid Battery, AGM Design	
Terminal Type	NB / IT	
Rated Capacity	30.4AH	(20hr, 1.75V/cell, 25°C/77°F)
	28.7AH	(10hr, 1.75V/cell, 25°C/77°F)
	25.5AH	(5hr, 1.75V/cell, 25°C/77°F)
	25.4AH	(3hr, 1.60V/cell, 25°C/77°F)
	18.9AH	(1hr, 1.60V/cell, 25°C/77°F)
Max. Discharge Current	300A	
Internal Resistance	13mΩ	
Operating Temp. Range	Discharge:	-20°C (-4°F)~50°C (122°F)
	Charge:	-20°C (-4°F)~50°C (122°F)
	Storage:	-20°C (-4°F)~40°C (104°F)
Nominal Operating Temp. Range	25±3°C (77±5°F)	
Container Material	ABS (Option: 94-HB & 94-V0 flame retardant case)	
Capacity affected by Temperature	40°C (104°F)	103%
	25°C (77°F)	100%
	0°C (32°F)	86%
Self Discharge	SigmasTek SP series batteries may be stored for up to 6 months at 25°C (77°F) and then a freshening charge is recommended. For higher temperatures the time interval will be shorter.	



Applications

- Uninterruptible Power Supply (UPS)
- Electric wheelchairs, scooters, bikes
- Electronic apparatus and equipment
- Alarm and security systems
- Emergency first responder equipment
- Emergency lighting
- Medical devices
- Electric carts
- Telecom equipment
- Switchgear
- Solar power systems



Constant Current Discharge (Amperes Per Battery) at 25°C (77°F)

F.V. (V/cell) \ Discharge Time	5min	15min	30min	1h	2h	3h	5h	8h	10h	20h
1.60V	115.8	58.2	32.86	18.9	11	8.45	5.55	3.63	3.02	1.57
1.67V	105	54.4	31.45	18.8	10.5	8.20	5.37	4.62	2.98	1.56
1.70V	95.2	51.2	31.40	17.7	10.4	7.86	5.23	4.52	2.92	1.54
1.75V	86.5	48.9	29.80	16.9	10.1	7.65	5.10	4.43	2.87	1.52
1.80V	76.6	43.2	28.08	16.8	9.7	7.51	4.97	4.31	2.79	1.50

Constant Power Discharge (Watts Per Cell) at 25°C (77°F)

F.V. (V/cell) \ Discharge Time	5min	15min	30min	1h	2h	3h	5h	8h	10h	20h
1.60V	1130	601.5	377.4	226.6	124.8	96.6	64.20	43.20	35.58	18.60
1.67V	1108	581.4	360	223.3	120.2	94.2	62.40	42.00	35.22	18.48
1.70V	1054	550.8	343.8	221	118.8	91.2	61.20	41.70	34.56	18.24
1.75V	918	523.2	332.4	210	116.4	88.8	59.52	41.16	33.90	17.94
1.80V	828	484.8	322.8	208	112.8	87.6	58.14	40.56	33.10	17.70

Dimensions

NB Terminal

Unit: mm (inches)

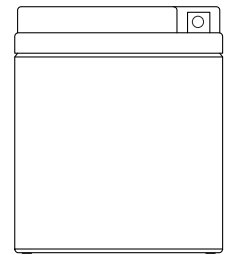
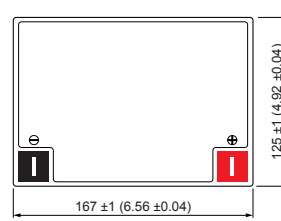
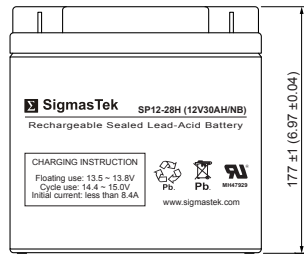
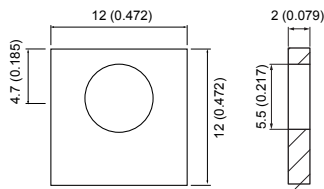

Cycle Service Life

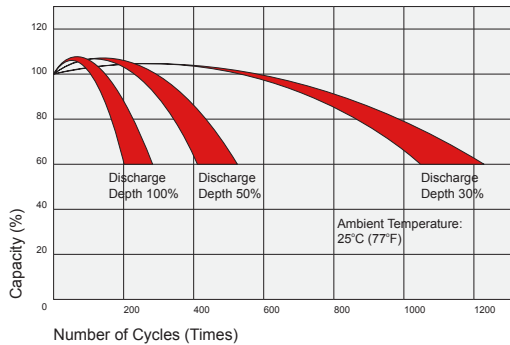

Self Discharge Characteristics

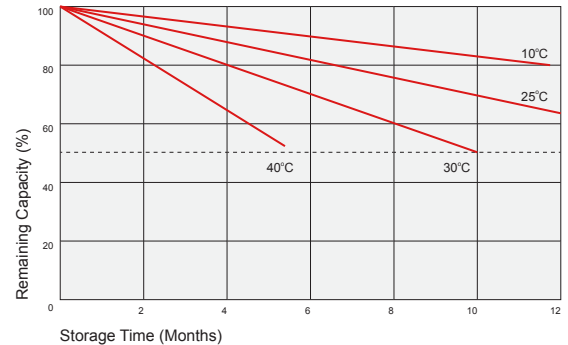

Discharge Characteristics

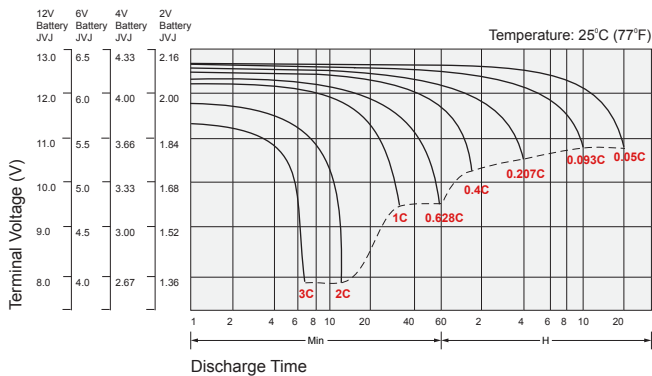

Float Charging Characteristics

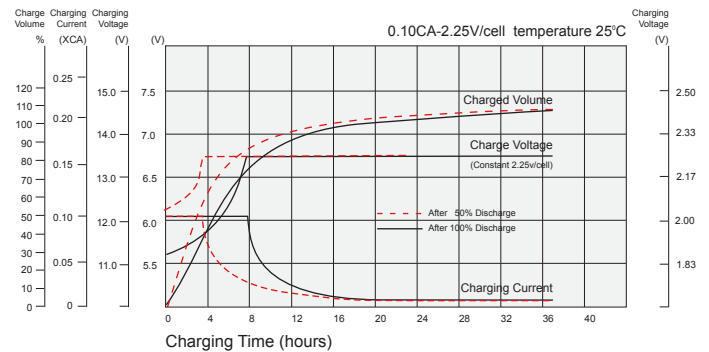

Temperature Effects in Relation to Battery Capacity

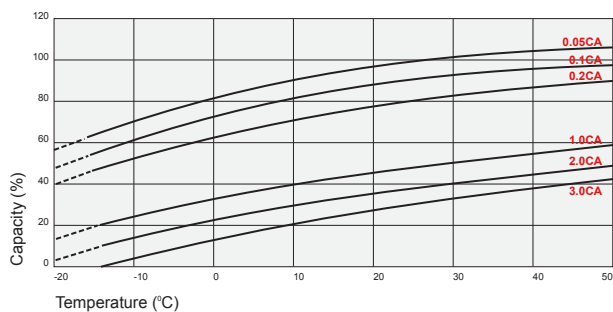

Temperature Effects on Long Term Float Life

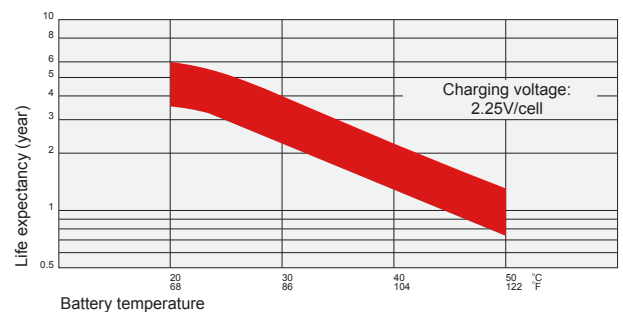

Contact Information

SigmasTek
7651 W 100th Place
Bridgeview, IL 60455, USA

T: (888) 988-8290
www.sigmasstek.com
order@sigmasstek.com