

Specifications

Nominal Voltage	12V	
Nominal Capacity (20HR)	112AH	
Dimension	Length	410mm (16.1 inches)
	Width	177mm (6.97 inches)
	Height	225mm (8.86 inches)
	Total Height (with Terminal)	225mm (8.86 inches)
	Approximate Weight	36 kg (79.38 lbs)
Battery Type	Valve Regulated Lead-Acid Battery, Gel Design	
Terminal Type	IT	
Rated Capacity	112.2AH	(20hr, 1.75V/cell, 25°C/77°F)
	102.3AH	(10hr, 1.75V/cell, 25°C/77°F)
	88.00AH	(5hr, 1.75V/cell, 25°C/77°F)
	85.50AH	(3hr, 1.60V/cell, 25°C/77°F)
	64.20AH	(1hr, 1.60V/cell, 25°C/77°F)
Max. Discharge Current	990A	
Internal Resistance	4.8mΩ	
Operating Temp. Range	Discharge:	-20°C (-4°F)~55°C (131°F)
	Charge:	0°C (32°F)~40°C (104°F)
	Storage:	-20°C (-4°F)~50°C (122°F)
Nominal Operating Temp. Range	25±3°C (77±5°F)	
Container Material	ABS (Option: 94-HB & 94-V0 flame retardant case)	
Capacity affected by Temperature	40°C (104°F)	103%
	25°C (77°F)	100%
	0°C (32°F)	86%
Self Discharge	SigmasTek SPG series batteries may be stored for up to 9 months at 25°C (77°F) and then a freshening charge is recommended. For higher temperatures the time interval will be shorter.	



Applications

- Uninterruptible Power Supply (UPS)
- Electric wheelchairs, scooters, bikes
- Electronic apparatus and equipment
- Alarm and security systems
- Emergency first responder equipment
- Emergency lighting
- Medical devices
- Electric carts
- Telecom equipment
- Switchgear
- Solar power systems



Constant Current Discharge (Amperes Per Battery) at 25°C (77°F)

F.V. (V/cell) \ Discharge Time	20min	30min	45min	1h	2h	3h	4h	5h	6h	7h	8h	9h	10h	20h
1.60V	145.5	106.9	78.5	64.2	38.4	28.5	22.8	19.1	16.3	14.3	12.8	11.7	10.8	5.82
1.67V	134.3	99.90	73.0	60.5	36.9	27.4	21.9	18.5	15.9	14.0	12.6	11.4	10.6	5.74
1.70V	129.0	96.10	70.5	58.3	36.0	26.6	21.4	18.2	15.7	13.8	12.4	11.3	10.5	5.68
1.75V	119.8	89.80	66.4	55.1	33.9	25.5	20.7	17.6	15.1	13.4	12.0	11.0	10.2	5.61
1.80V	106.6	81.60	61.5	51.5	32.0	24.2	19.8	16.9	14.6	12.9	11.6	10.7	10.0	5.50
1.85V	93.10	73.00	55.7	46.6	29.6	22.6	18.7	16.1	13.9	12.3	11.1	10.2	9.60	5.28

Constant Power Discharge (Watts Per Cell) at 25°C (77°F)

F.V. (V/cell) \ Discharge Time	20min	30min	45min	1h	2h	3h	4h	5h	6h	7h	8h	9h	10h	20h
1.60V	263.0	196.5	146.7	121.7	73.4	54.9	44.1	37.1	31.8	28.0	25.2	23.1	21.4	11.5
1.67V	245.4	185.3	137.6	115.3	70.9	53.0	42.6	36.1	31.2	27.5	24.8	22.6	21.0	11.4
1.70V	238.4	180.3	133.8	111.7	69.4	51.6	41.7	35.5	30.7	27.2	24.5	22.4	20.8	11.3
1.75V	223.8	169.8	127.0	106.2	65.8	49.7	40.5	34.5	29.8	26.4	23.8	21.8	20.3	11.2
1.80V	201.3	155.8	118.3	99.70	62.3	47.2	38.8	33.3	28.8	25.5	23.1	21.2	20.0	11.0
1.85V	178.1	140.7	108.1	90.80	57.8	44.2	36.7	31.8	27.6	24.5	22.1	20.2	19.1	10.5

Dimensions

IT Terminal

Unit: mm (inches)

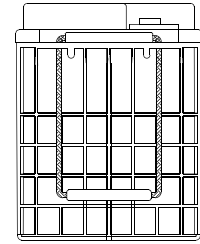
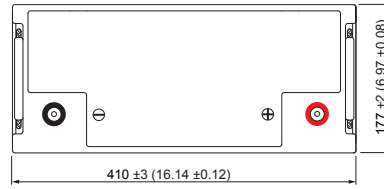
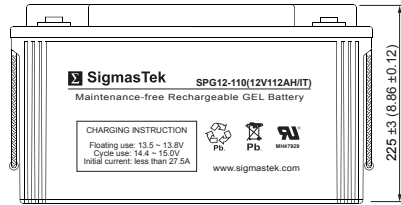
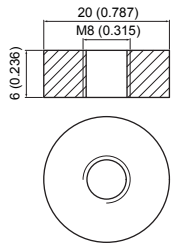

Cycle Service Life

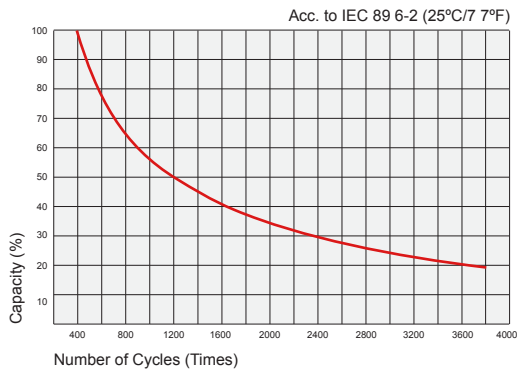

Self Discharge Characteristics

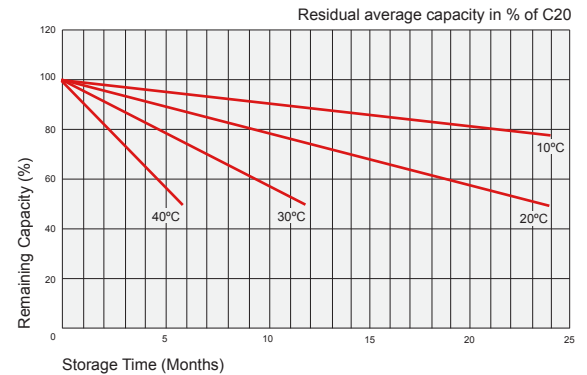

Discharge Characteristics

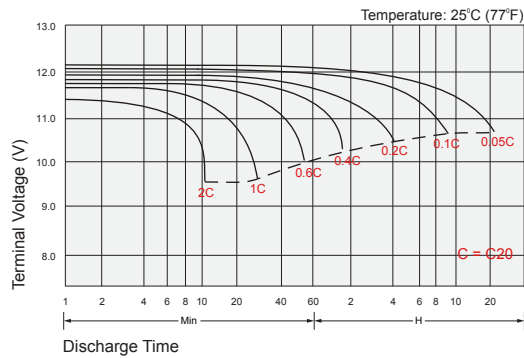

Float Charging Characteristics

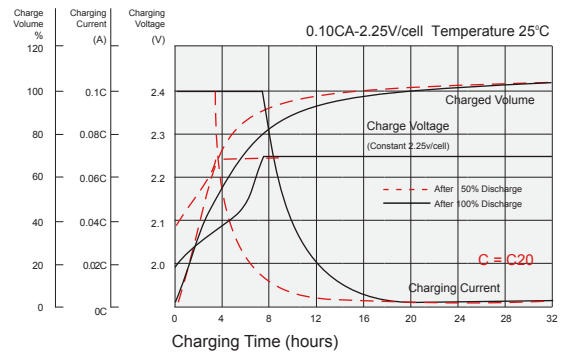

Temperature Effects in Relation to Battery Capacity

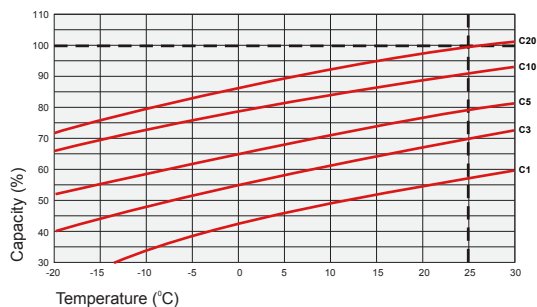

Temperature Effects on Long Term Float Life

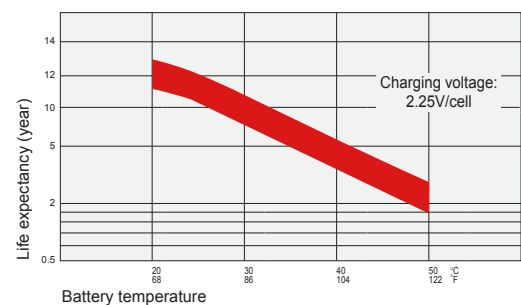

Contact Information

SigmasTek
7651 W 100th Place
Bridgeview, IL 60455, USA

T: (888) 988-8290
www.sigmastek.com
order@sigmastek.com